

BASE CABINETS

CABINET SPECIFICATION

DIMENSION

BASE CABINET - 1 DRAWER, 1 DOOR, 1 ADJUSTABLE SHELF

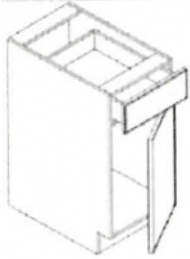

ITEM CODE	WIDTH"	HEIGHT"	DEPTH"	
B09	09	34.5	24	
B12	12	34.5	24	
B15	15	34.5	24	
B18	18	34.5	24	
B21	21	34.5	24	

BASE CABINET - 1 DRAWER, 2 DOORS, 1 ADJUSTABLE SHELF

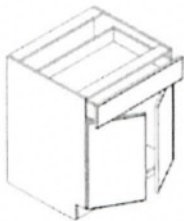

ITEM CODE	WIDTH"	HEIGHT"	DEPTH"	
B24	24	34.5	24	
B27	27	34.5	24	
B30	30	34.5	24	
B33	33	34.5	24	
B36	36	34.5	24	
B39	39	34.5	24	
B42	42	34.5	24	

BASE DRAWER CABINET - 3 DRAWERS

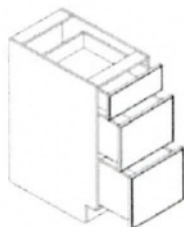

ITEM CODE	WIDTH"	HEIGHT"	DEPTH"	
DB12-3	12	34.5	24	
DB15-3	15	34.5	24	
DB18-3	18	34.5	24	
DB21-3	21	34.5	24	
DB24-3	24	34.5	24	
DB27-3	27	34.5	24	
DB30-3	30	34.5	24	
DB33-3	33	34.5	24	
DB36-3	36	34.5	24	

SINK BASE CABINET - 1 DUMMY DRAWER, 2 DOORS

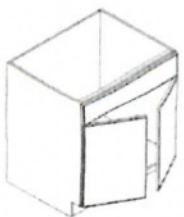

ITEM CODE	WIDTH"	HEIGHT"	DEPTH"	
SB24	24	34.5	24	
SB27	27	34.5	24	
SB30	30	34.5	24	
SB33	33	34.5	24	
SB36	36	34.5	24	
SB39	39	34.5	24	
SB42	42	32.5	24	

BASE CABINETS

CABINET SPECIFICATION

DIMENSION

BASE WASTE BASKET CABINET - 1 DRAWER, 1 PULL-OUT DOOR

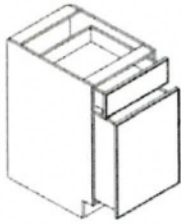

ITEM CODE	WIDTH"	HEIGHT"	DEPTH"	
BWBK18	18	34.5	24	
NOTE: TRASH CAN SOLD SEPERATELY				

LAZY SUSAN CABINET - 2 FULL HEIGHT FOLDING DOORS

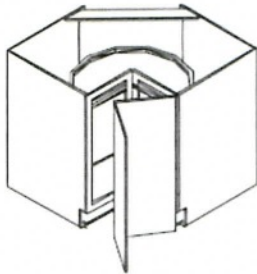

ITEM CODE	WIDTH"	HEIGHT"	DEPTH"	
BLS33	33	34.5	24	
BLS36	36	34.5	24	
NOTE: METAL LAZY SUSAN SPINNER SOLD SEPERATELY				

BASE DIAGONAL CABINET - 1 DOOR, 1 ADJUSTABLE SHELF

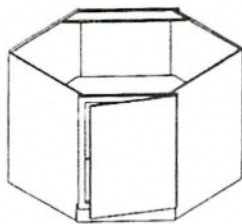

ITEM CODE	WIDTH"	HEIGHT"	DEPTH"	
BDC36	36	34.5	24	
NOTE: This can also be used as a corner Sink Base cabinet, just leave out the shelf				

BASE BLIND CORNER CABINET - 1 DOOR, 1 DRAWER, 1 ADJUSTABLE SHELF

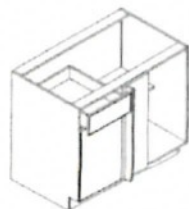

ITEM CODE	WIDTH"	HEIGHT"	DEPTH"	
BBC39	39	34.5	24	
BBC42	42	34.5	24	
BBC45	45	34.5	24	
NOTE: BBC39 Door 12" Wide, BBC42 Door 15" Wide and BBC45" Door 18" Wide				

BASE SPICE RACK CABINET - 1 FULL HEIGHT DOOR (PULL-OUT), 3 FIXED SHELVES

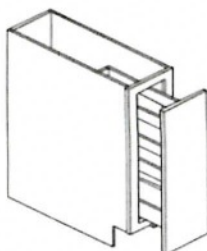

ITEM CODE	WIDTH"	HEIGHT"	DEPTH"	
BSR09	09	34.5	24	

BASE CABINETS

CABINET SPECIFICATION

DIMENSION

BASE WINE RACK

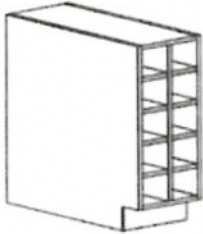

ITEM CODE	WIDTH"	HEIGHT"	DEPTH"	
BWR12	12	34.5	24	

BASE SPICE DRAWER - 5 SPICE DRAWER

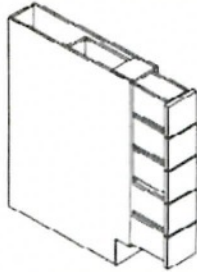

ITEM CODE	WIDTH"	HEIGHT"	DEPTH"	
BSDC06	06	34.5	24	

BASE END ANGLE CABINET - 1 DOOR, 1 FAKE DRAWER, 1 ADJUSTABLE SHELF

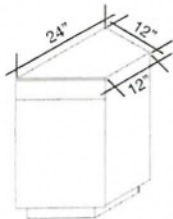

ITEM CODE	WIDTH"	HEIGHT"	DEPTH"	
BEA12L	12	34.5	24	
BEA12R	12	34.5	24	

BASE OPEN END SHELF 12" - NO DOOR, 2 FIXED SHELVES

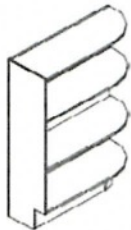

ITEM CODE	WIDTH"	HEIGHT"	DEPTH"	
BOES12L	12	34.5	24	
BOES12R	12	34.5	24	

NOTE: BOES12L IS ON THE LEFT & BOES12R IS ON RIGHT

KNEE DRAWER - 1 DRAWER

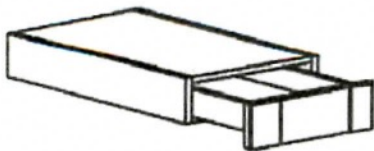

ITEM CODE	WIDTH"	HEIGHT"	DEPTH"	
KDD24	24	4	21	
KDD30	30	4	21	
KDD36	36	4	21	

BASE KITCHEN-SIZE DRAWER - 1 DRAWER

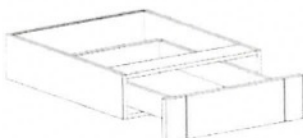

ITEM CODE	WIDTH"	HEIGHT"	DEPTH"	
BKD24	24	7.25	21	
BKD30	30	7.25	21	
BKD36	36	7.25	21	

WALL CABINETS

CABINET SPECIFICATION

DIMENSION

WALL CABINET - 1 DOOR, 2 ADJUSTABLE SHELVES

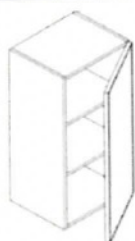

ITEM CODE	WIDTH"	HEIGHT"	DEPTH"	
W0930	09	30	12	
W1230	12	30	12	
W1530	15	30	12	
W1830	18	30	12	
W2130	21	30	12	

WALL CABINET - 2 DOORS, 2 ADJUSTABLE SHELVES

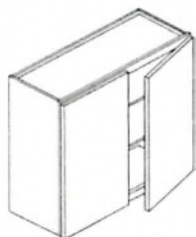

ITEM CODE	WIDTH"	HEIGHT"	DEPTH"	
W2430	24	30	12	
W2730	27	30	12	
W3030	30	30	12	
W3330	33	30	12	
W3630	36	30	12	

WALL CABINET - 1 DOOR, 2 ADJUSTABLE SHELVES

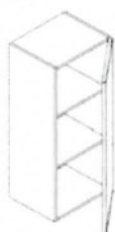

ITEM CODE	WIDTH"	HEIGHT"	DEPTH"	
W0936	09	36	12	
W1236	12	36	12	
W1536	15	36	12	
W1836	18	36	12	
W2136	21	36	12	

WALL CABINET - 1 DOOR, 2 ADJUSTABLE SHELVES

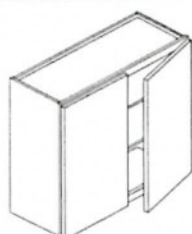

ITEM CODE	WIDTH"	HEIGHT"	DEPTH"	
W2436	24	36	12	
W2736	27	36	12	
W3036	30	36	12	
W3336	33	36	12	
W3636	36	36	12	

WALL CABINET - 1 DOOR, 3 ADJUSTABLE SHELVES



ITEM CODE	WIDTH"	HEIGHT"	DEPTH"	
W0942	09	42	12	
W1242	12	42	12	
W1542	15	42	12	
W1842	18	42	12	
W2142	21	42	12	

WALL CABINET - 2 DOORS, 3 ADJUSTABLE SHELVES



ITEM CODE	WIDTH"	HEIGHT"	DEPTH"	
W2442	24	42	12	
W2742	27	42	12	
W3042	30	42	12	
W3342	33	42	12	
W3642	36	42	12	

WALL CABINETS

CABINET SPECIFICATION

DIMENSION

WALL CABINET - 2 DOORS, NO SHELF

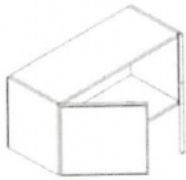

ITEM CODE	WIDTH"	HEIGHT"	DEPTH"	
W3012	30	12	12	
W3015	30	15	12	
W3018	30	18	12	
W3021	30	21	12	
W3612	36	12	12	
W3615	36	15	12	
W3618	36	18	12	
W3621	36	21	12	

WALL CABINET - 2 DOORS, 1 ADJUSTABLE SHELF



ITEM CODE	WIDTH"	HEIGHT"	DEPTH"	
W3024	30	24	12	
W3624	36	24	12	

WALL CABINET - 2 DOORS, NO SHELF

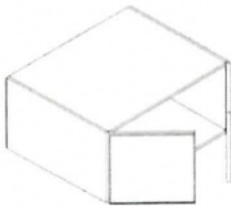

ITEM CODE	WIDTH"	HEIGHT"	DEPTH"	
W3612-24	36	12	24	
W3615-24	36	15	24	
W3618-24	36	18	24	

WALL CABINET - 2 DOORS, 1 ADJUSTABLE SHELF

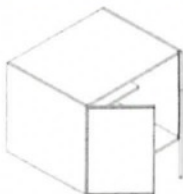

ITEM CODE	WIDTH"	HEIGHT"	DEPTH"	
W3624-24	36	24	24	

WALL DIAGONAL CORNER - 1 DOOR, 2 ADJUSTABLE SHELVES



ITEM CODE	WIDTH"	HEIGHT"	DEPTH"	
WDC2430	24	30	12	
WDC2436	24	36	12	
WDC2436-15	24	36	15	

WALL DIAGONAL CORNER - 1 DOOR, 3 ADJUSTABLE SHELVES

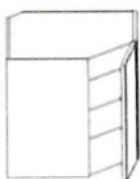

ITEM CODE	WIDTH"	HEIGHT"	DEPTH"	
WDC2442	24	42	12	
WDC2442-15	24	42	15	

WALL CABINETS

CABINET SPECIFICATION

DIMENSION

WALL STEM GLASS HOLDER



ITEM CODE	WIDTH"	HEIGHT"	DEPTH"	
SGH3012	30	1.75	12	
SGH3612	36	1.75	12	

NOTE: SGH3012 HAS 8 SLOTS, SGH3612 HAS 10 SLOTS

WALL WINE RACK CABINET

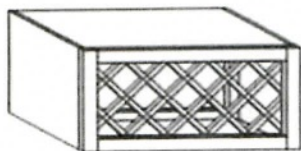

ITEM CODE	WIDTH"	HEIGHT"	DEPTH"	
WRC3015	30	15	12	
WRC3018	30	18	12	
WRC3615	36	15	12	
WRC3618	36	18	12	

WALL OPEN END SHELF - NO DOOR, 2 FIXED SHELVES



ITEM CODE	WIDTH"	HEIGHT"	DEPTH"	
WOES1230	12	30	12	
WOES1236	12	36	12	

WALL OPEN END SHELF - NO DOOR, 3 FIXED SHELVES



ITEM CODE	WIDTH"	HEIGHT"	DEPTH"	
WOES1242	12	42	12	

WALL END ANGLE CABINET- 1 DOOR, 2-3 SHELVES



ITEM CODE	WIDTH"	HEIGHT"	DEPTH"	
WEA1230	12	30	12	
WEA1236	12	36	12	
WEA1242	12	42	12	

NOTE: MUST SPECIFY LEFT OR RIGHT WHEN ORDERING THE WEA CABINET

WALL SMALL DRAWER CABINET - 2 DRAWERS

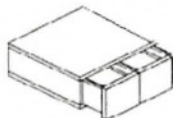

ITEM CODE	WIDTH"	HEIGHT"	DEPTH"	
WSD1206	12	06	12	

WALL SMALL DRAWER CABINET - 3 DRAWERS

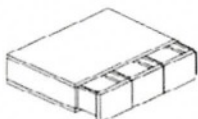

ITEM CODE	WIDTH"	HEIGHT"	DEPTH"	
WSD1806	18	06	12	

WALL CABINETS

CABINET SPECIFICATION

DIMENSION

WALL MULLION DOOR CABINET - 1 DOOR, 2 ADJUSTABLE SHELVES, GLASS NOT INCLUDED



ITEM CODE	WIDTH"	HEIGHT"	DEPTH"	
WMD1230	12	30	12	
WMD1530	15	30	12	
WMD1830	18	30	12	
WMD2130	21	30	12	

WALL MULLION DOOR CABINET - 2 DOORS, 2 ADJUSTABLE SHELVES, GLASS NOT INCLUDED

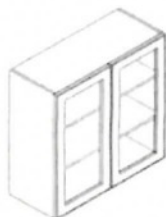

ITEM CODE	WIDTH"	HEIGHT"	DEPTH"	
WMD2430	24	30	12	
WMD2730	27	30	12	
WMD3030	30	30	12	
WMD3330	33	30	12	
WMD3630	36	30	12	

WALL MULLION DOOR CABINET - 1 DOOR, 2 ADJUSTABLE SHELVES, GLASS NOT INCLUDED

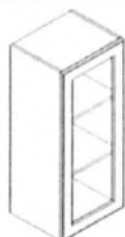

ITEM CODE	WIDTH"	HEIGHT"	DEPTH"	
WMD1236	12	36	12	
WMD1536	15	36	12	
WMD1836	18	36	12	
WMD2136	21	36	12	

WALL MULLION DOOR CABINET - 2 DOORS, 2 ADJUSTABLE SHELVES, GLASS NOT INCLUDED

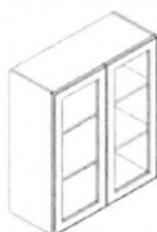

ITEM CODE	WIDTH"	HEIGHT"	DEPTH"	
WMD2436	24	36	12	
WMD2736	27	36	12	
WMD3036	30	36	12	
WMD3336	33	36	12	
WMD3636	36	36	12	

WALL MULLION DOOR CABINET - 1 DOOR, 3 ADJUSTABLE SHELVES, GLASS NOT INCLUDED

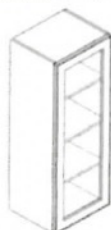

ITEM CODE	WIDTH"	HEIGHT"	DEPTH"	
WMD1242	12	42	12	
WMD1542	15	42	12	
WMD1842	18	42	12	
WMD2142	21	42	12	

WALL MULLION DOOR CABINET - 2 DOORS, 3 ADJUSTABLE SHELVES, GLASS NOT INCLUDED



ITEM CODE	WIDTH"	HEIGHT"	DEPTH"	
WMD2442	24	42	12	
WMD2742	27	42	12	
WMD3042	30	42	12	
WMD3342	33	42	12	
WMD3642	36	42	12	

WALL CABINETS

CABINET SPECIFICATION

DIMENSION

WALL DIAGONAL MULLION DOOR CABINET - 1 DOOR, 2 ADJUSTABLE SHELVES, GLASS NOT INCLUDED

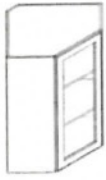

ITEM CODE	WIDTH"	HEIGHT"	DEPTH"	
WDCMD2430	24	30	15	
WDCMD2436	24	36	15	
WDCMD2436-15	24	36	15	

WALL DIAGONAL MULLION DOOR CABINET - 1 DOOR, 3 ADJUSTABLE SHELVES, GLASS NOT INCLUDED

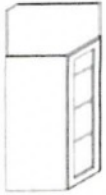

ITEM CODE	WIDTH"	HEIGHT"	DEPTH"	
WDCMD2442	24	42	12	
WDCMD2442-15	24	42	15	

WALL DISH - HOLDER CABINET

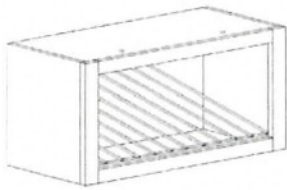

ITEM CODE	WIDTH"	HEIGHT"	DEPTH"	
WCD3015	30	15	15	

TALL CABINETS

CABINET SPECIFICATION

DIMENSION

TALL PANTRY, 1 UPPER DOOR AND, 1 LOWER DOOR



ITEM CODE	WIDTH"	HEIGHT"	DEPTH"	
PC1884	18	84	24	
PC1890	18	90	24	
PC1896	18	96	24	
NOTE: PANTRY CABINETS OF MODEL-P COME WITH 27" DEPTH				

TALL PANTRY - 2 UPPER DOORS AND 2 LOWER DOORS



ITEM CODE	WIDTH"	HEIGHT"	DEPTH"	
PC2484	24	84	24	
PC2490	24	90	24	
PC2496	24	96	24	
PC3084	30	84	24	
PC3090	30	90	24	
PC3096	30	96	24	

DOUBLE OVEN CABINET - 2 UPPER DOORS AND 1 LOWER DRAWER

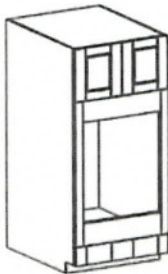

ITEM CODE	WIDTH"	HEIGHT"	DEPTH"	
DOC3084	30	84	24	
DOC3090	30	90	24	
DOC3096	30	96	24	
NOTE: DOUBLE OVEN OPENING 28 1/2" X 56 1/4" (INSIDE DIMENSION) CABINET COMES WITH TRIM MATERIAL				

SINGLE OVEN CABINET - 2 UPPER DOORS AND 2 LOWER DOORS

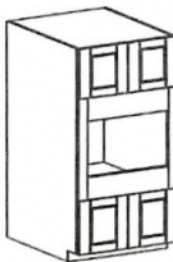

ITEM CODE	WIDTH"	HEIGHT"	DEPTH"	
SOC3084	30	84	24	
SOC3090	30	90	24	
SOC3096	30	96	24	
NOTE: SINGLE OVEN OPENING 28 1/2" X 41 1/2" (INSIDE DIMENSION) CABINET COMES WITH TRIM MATERIAL				

VANITY CABINETS

ITEM SPECIFICATION

DIMENSION

VANITY DRAWER BASE CABINET - 3 DRAWERS



ITEM CODE	WIDTH"	HEIGHT"	DEPTH"	
VBD12-3	12	32.5	21	
VBD15-3	15	32.5	21	
VBD18-3	18	32.5	21	
VBD21-3	21	32.5	21	

VANITY SINK BASE CABINET - 1 DUMMY DRAWER, 2 DOORS

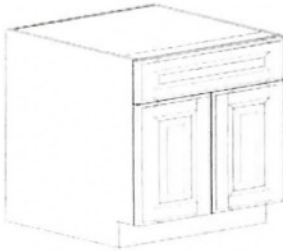

ITEM CODE	WIDTH"	HEIGHT"	DEPTH"	
VS24	24	32.5	21	
VS27	27	32.5	21	
VS30	30	32.5	21	
VS36	36	32.5	21	

MOLDINGS & ACCESSORIES

ITEM SPECIFICATION

DIMENSION

DOOR PANEL

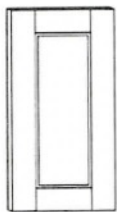

ITEM CODE	WIDTH"	HEIGHT"	DEPTH"	
D1230W	12	30	3/4	
D1236W	12	36	3/4	
D1242W	12	42	3/4	
D2430B	24	30	3/4	

FLUTED FILLER

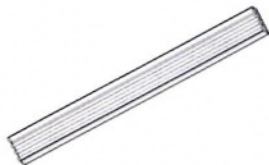

ITEM CODE	WIDTH"	HEIGHT"	DEPTH"	
RWF330	3	30	3/4	
RWF336	3	36	3/4	
RWF342	3	42	3/4	
RWF396	3	96	3/4	

FILLER



ITEM CODE	WIDTH"	HEIGHT"	DEPTH"	
WF330	3	30	3/4	
WF336	3	36	3/4	
WF342	3	42	3/4	
WF396	3	96	3/4	
WF642	6	42	3/4	

ROLL OUT TRAY - (Full Extension Track Included)



ITEM CODE	WIDTH"	HEIGHT"	DEPTH"	
ROT15	15	3	21	
ROT18	18	3	21	
ROT21	21	3	21	
ROT24	24	3	21	
ROT27	27	3	21	
ROT30	30	3	21	
ROT33	33	3	21	
ROT36	36	3	21	

FINISHED PANEL - FINISHED EDGE AT ALL SIDES

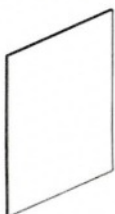

ITEM CODE	WIDTH"	HEIGHT"	DEPTH"	
PNL2496	24	96	3/4	
PNL3596	36	96	3/4	
PNL4896	48	96	3/4	
DWR (L/R)	24	35	3/4	

MOLDINGS & ACCESSORIES

ITEM SPECIFICATION

DIMENSION

CORBEL - STAIN FINISH



ITEM CODE	WIDTH"	HEIGHT"	DEPTH"	
COR-S	3	6	3	
COR-M	4 1/2	12	4 1/4	
COR-L	5 1/2	15	6 1/2	

CLASSIC CROWN MOLDING



ITEM CODE	WIDTH"	LENGTH"		
CCM8	3 1/2	96		

NOTE: MODEL H & K COME WITH ROPE ON CCM8

ANGLED CROWN MOLDING



ITEM CODE	WIDTH"	LENGTH"		
ACM8	3 1/2	96		

NOTE: ACM8 IS FOR MODEL B & W ONLY

COUNTER TOP MOLDING

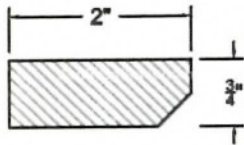

ITEM CODE	WIDTH"	LENGTH"		
CTM8	3/4	96		

NOTE: CTM8 IS FOR MODEL B & W ONLY

OGEE MOLDING

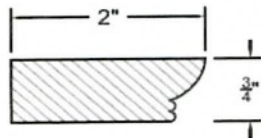

ITEM CODE	WIDTH"	LENGTH"		
OGM8	3/4	96		

NOTE: LENGTH OF ALL MOLDINGS MADE OF FINGER - JOINTED MATERIAL

VALANCE



ITEM CODE	WIDTH"	HEIGHT"	DEPTH"	
VAL30	30	4 1/2	3/4	
VAL36	36	4 1/2	3/4	
VAL42	42	4 1/2	3/4	
VAL48	48	4 1/2	3/4	
VAL60	60	4 1/2	3/4	

MOLDINGS & ACCESSORIES

ITEM SPECIFICATION

DIMENSION

LIGHT RAIL MOLDING



ITEM CODE	WIDTH"	LENGTH"		
IVI8	2	96		

OUTSIDE CORNER MOLDING

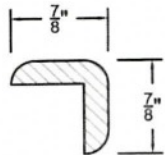

ITEM CODE	WIDTH"	LENGTH"		
OCM8	1	96		

QUARTER ROUND MOLDING



ITEM CODE	WIDTH"	LENGTH"		
QR8	3/4	96		

SCRIBE MOLDING/TRIM MOLDING

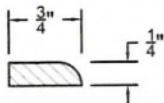

ITEM CODE	WIDTH"	LENGTH"		
SM8	3/4	96		

TOE KICK



ITEM CODE	WIDTH"	LENGTH"		
TK8	4 1/2	96		

SPOOL



ITEM CODE	WIDTH"	HEIGHT"	DEPTH"	
SPOOL	3	36	3	
SPOOL 4.5	4 1/2	36	4 1/2	

MOLDINGS & ACCESSORIES

ITEM SPECIFICATION

DIMENSION

ROSETTE - APPLIQUE

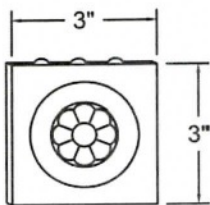

ITEM CODE

WIDTH"

HEIGHT"

DEPTH"

FLOWER

3

3

3/8

NOTE: APPLIQUE HAS 3 RAISED RIBS ON BACK, INTENDED TO BE USED WITH FLUTED FILLER (RWF)

TRIPLE BEAD MOLDING

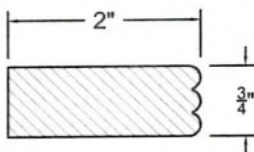

ITEM CODE

WIDTH"

LENGTH"

TBM8

2

96

SMALL DENTAL MOLDING

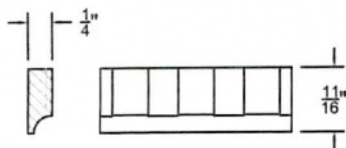

ITEM CODE

WIDTH"

LENGTH"

DEN3

1/4

96

CORNER LIGHT RAIL MOLDING

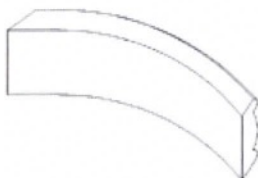

ITEM CODE

WIDTH"

LENGTH"

IVITC6

2

6

HIGH VALANCE

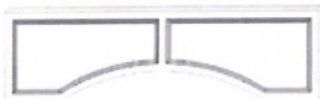

ITEM CODE

WIDTH"

HEIGHT"

DEPTH"

VAL36-12

36

12

3/4

VAL42-12

42

12

3/4

VAL48-12

48

12

3/4

Standard Wall Cabinet Construction Specifications:

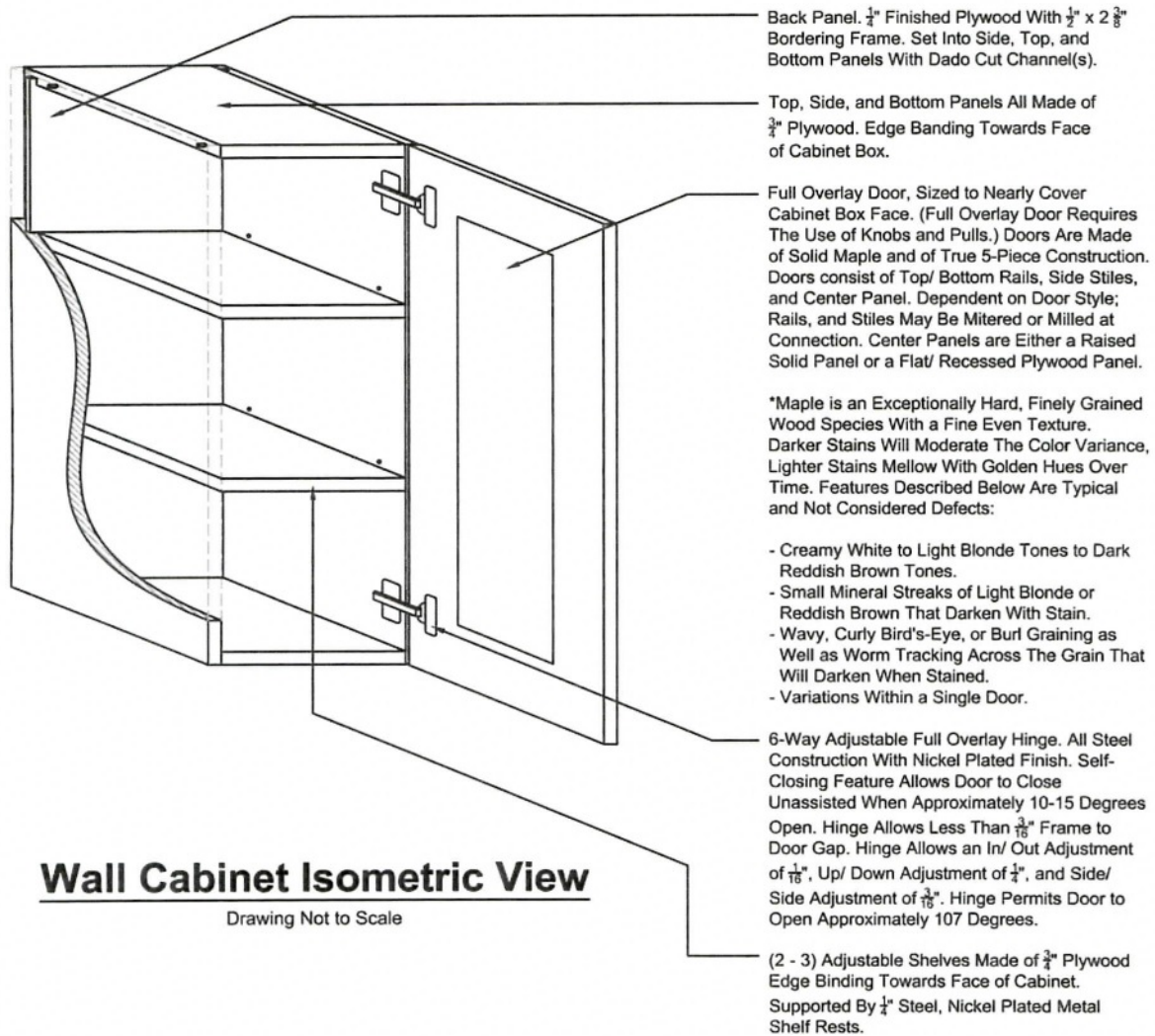

Wall Cabinet Isometric View

Drawing Not to Scale

Standard Base Cabinet Construction Specifications:

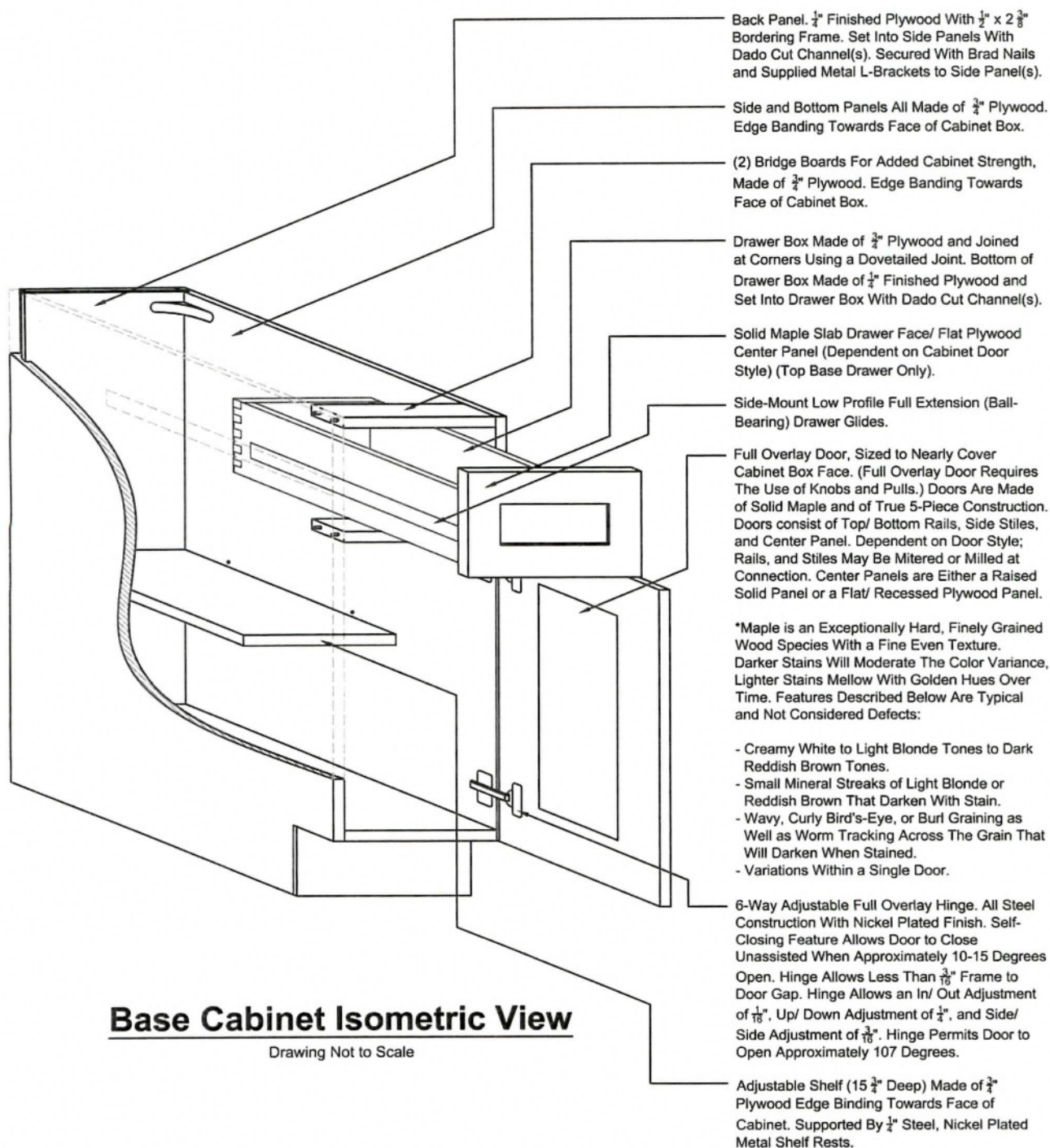

Base Cabinet Isometric View

Drawing Not to Scale

ASSEMBLY INSTRUCTIONS

Wall Cabinet Assembly Instructions:

Supplied Parts List:

- (A) Side Panel (Left)
- (B) Back Panel
- (C) Side Panel (Right)
- (D) Door
- (E)/(F) Top/ Bottom Panel (Similar)
- (G) (2-3) Adjustable Shelves

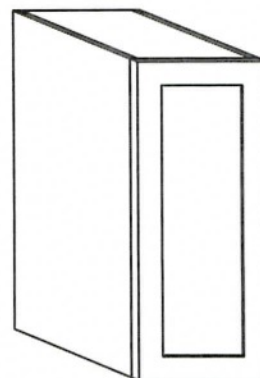

Assembled Cabinet

Drawing Not to Scale

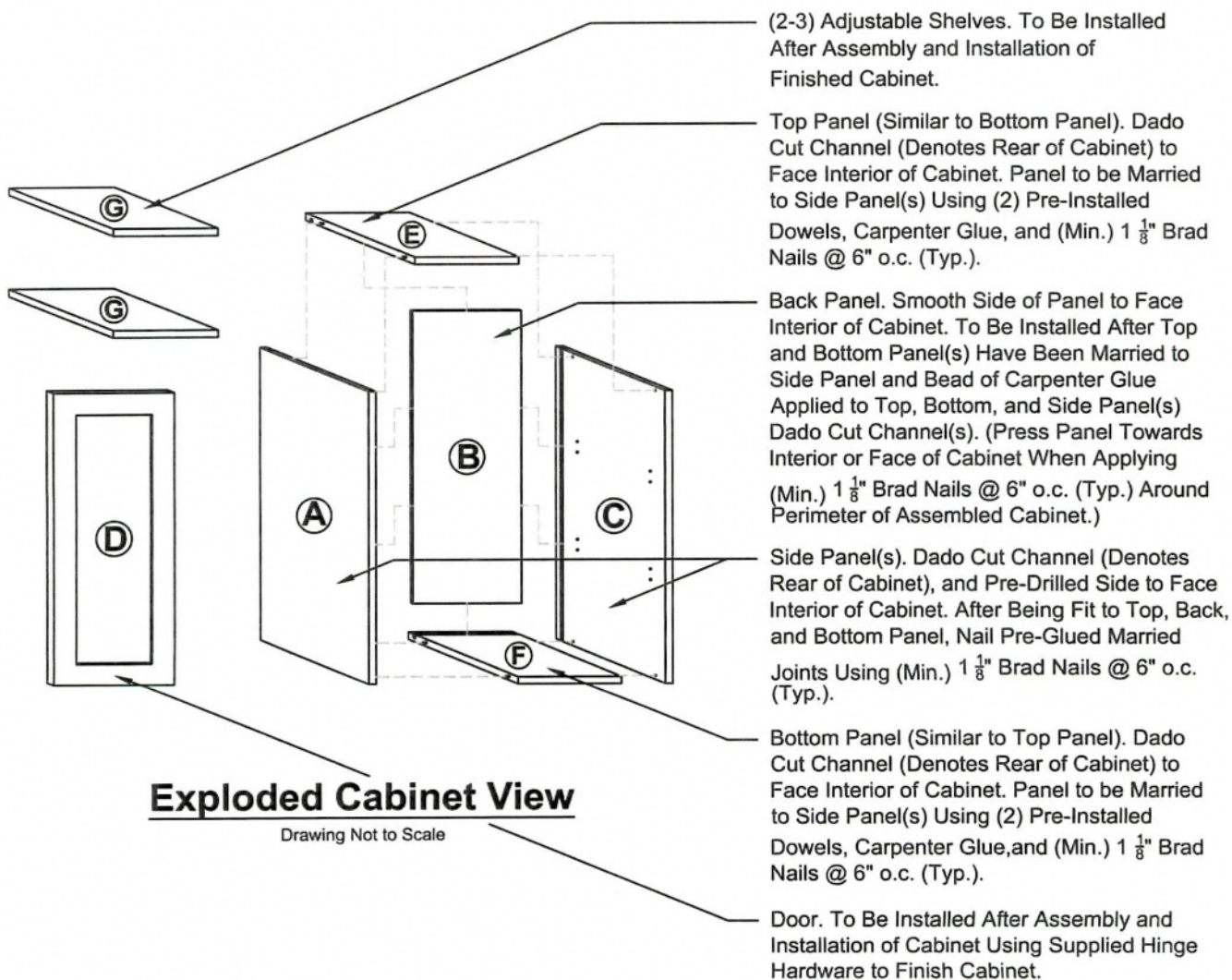

ASSEMBLY INSTRUCTIONS

Base Cabinet Assembly Instructions:

Supplied Parts List:

- (A) Side Panel (Left)
- (B) Back Panel
- (C) Side Panel (Right)
- (D) Drawer Face
- (E) Door
- (F) (2) Bridge Board(s)
- (G) Adjustable Shelf
- (H) Bottom Panel
- (I) Drawer Box Back
- (J) Drawer Box Side (Left)
- (K) Drawer Box Bottom Panel
- (L) Drawer Box Side (Right)

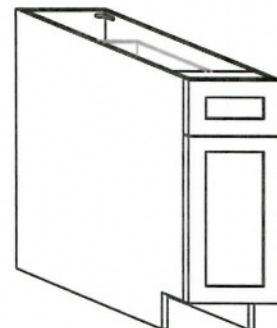

Assembled Cabinet

Drawing Not to Scale

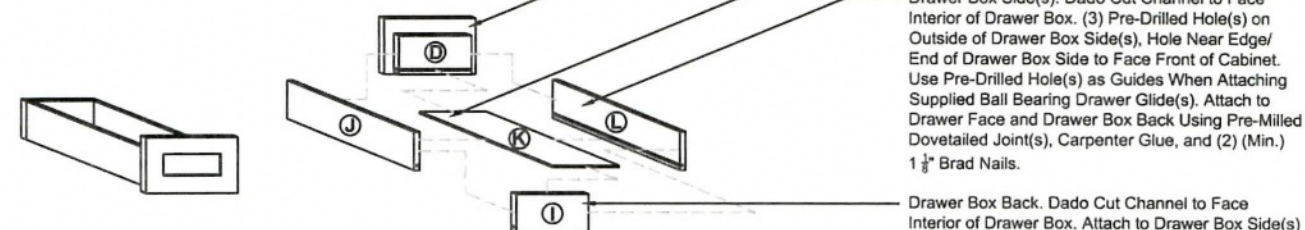

Assembled Drawer

Shown From Front - Drawing Not to Scale

Exploded Drawer View

Shown From Rear - Drawing Not to Scale

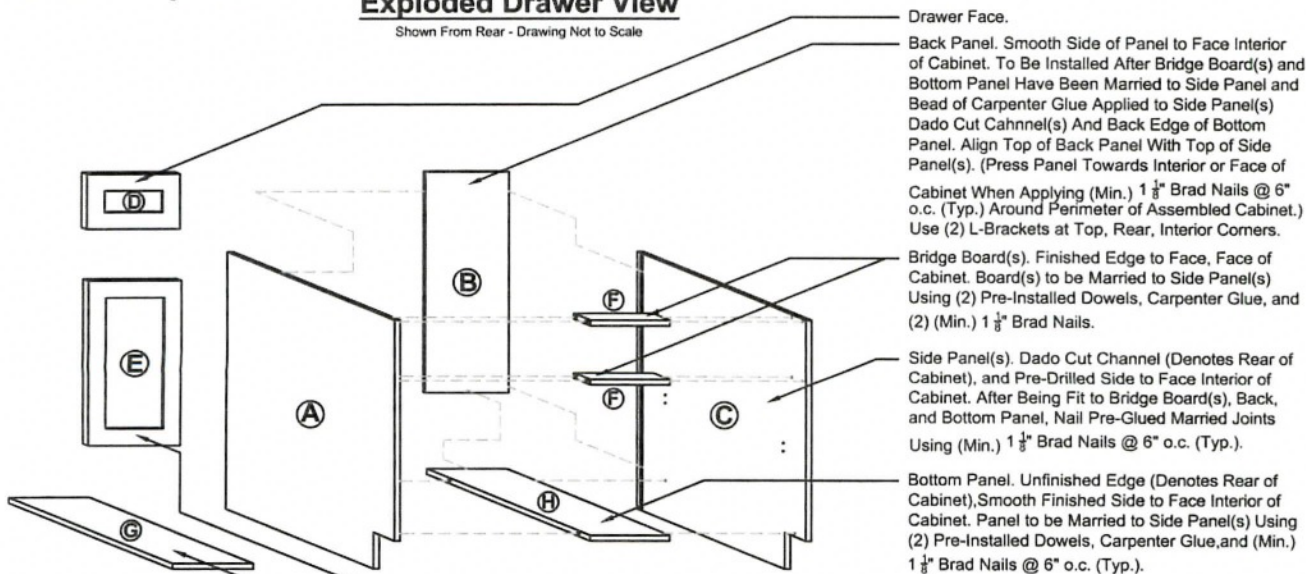

Exploded Cabinet View

Drawing Not to Scale

Drawer Face. Attach to Drawer Box Side(s) Using Pre-Milled Dovetailed Joint(s), Carpenter Glue, and (2) (Min.) $1\frac{1}{8}$ " Brad Nails.

Drawer Box Bottom Panel. To Be Installed After Drawer Face, Drawer Box Side, and Drawer Box Back Have Been Married Together and Bead of Carpenter Glue Applied to Stated Part's Dado Cut Channel(s).

Drawer Box Side(s). Dado Cut Channel to Face Interior of Drawer Box. (3) Pre-Drilled Hole(s) on Outside of Drawer Box Side(s), Hole Near Edge/End of Drawer Box Side to Face Front of Cabinet. Use Pre-Drilled Hole(s) as Guides When Attaching Supplied Ball Bearing Drawer Glide(s). Attach to Drawer Face and Drawer Box Back Using Pre-Milled Dovetailed Joint(s), Carpenter Glue, and (2) (Min.) $1\frac{1}{8}$ " Brad Nails.

Drawer Box Back. Dado Cut Channel to Face Interior of Drawer Box. Attach to Drawer Box Side(s) Using Pre-Milled Dovetailed Joint(s), Carpenter Glue, and (2) (Min.) $1\frac{1}{8}$ " Brad Nails.

Drawer Face.

Back Panel. Smooth Side of Panel to Face Interior of Cabinet. To Be Installed After Bridge Board(s) and Bottom Panel Have Been Married to Side Panel and Bead of Carpenter Glue Applied to Side Panel(s) Dado Cut Channel(s) And Back Edge of Bottom Panel. Align Top of Back Panel With Top of Side Panel(s). (Press Panel Towards Interior or Face of Cabinet When Applying (Min.) $1\frac{1}{8}$ " Brad Nails @ 6" o.c. (Typ.) Around Perimeter of Assembled Cabinet.) Use (2) L-Brackets at Top, Rear, Interior Corners.

Bridge Board(s). Finished Edge to Face, Face of Cabinet. Board(s) to be Married to Side Panel(s) Using (2) Pre-Installed Dowels, Carpenter Glue, and (2) (Min.) $1\frac{1}{8}$ " Brad Nails.

Side Panel(s). Dado Cut Channel (Denotes Rear of Cabinet), and Pre-Drilled Side to Face Interior of Cabinet. After Being Fit to Bridge Board(s), Back, and Bottom Panel, Nail Pre-Glued Married Joints Using (Min.) $1\frac{1}{8}$ " Brad Nails @ 6" o.c. (Typ.).

Bottom Panel. Unfinished Edge (Denotes Rear of Cabinet). Smooth Finished Side to Face Interior of Cabinet. Panel to be Married to Side Panel(s) Using (2) Pre-Installed Dowels, Carpenter Glue, and (Min.) $1\frac{1}{8}$ " Brad Nails @ 6" o.c. (Typ.).

Door. To Be Installed After Assembly and Installation of Cabinet Using Supplied Hinge Hardware to Finish Cabinet.

Adjustable Shelf. To Be Installed After Assembly and Installation of Finished Cabinet.

PRODUCT SPECIFICATIONS

NKBA Kitchen Guidelines

Door/Entry:

Door opening should be at least 32" wide.

Door Interference:

Entry door should not interfere with safe appliance operation or appliance doors.

Distance Between Work Centers:

With three work centers, the total distance traveled should not be more than 26' with no single leg of the triangle less than 4' or more than 9'.

With more than three work centers, each additional travel distance to another work center should be no less than 4' or more than 9'. Each leg is measured from the center-front of the appliance/sink. No work triangle leg should intersect an island/peninsula by more than 12".

Separating Work Centers:

A tall obstacle should not separate two primary work centers. A properly recessed tall corner unit is acceptable.

Work Triangle Traffic:

Major traffic patterns should not cross through the basic work triangle.

Work Aisle:

The work aisle should be at least 42" for one cook and at least 48" for multiple cooks.

Walkway:

The walkway width should be at least 36".

Traffic Clearance At Seating:

Allow 32" of clearance from the table to wall/obstacle if no traffic passes behind a seated diner. If traffic passes behind the diner, allow at least 36" to edge past or 44" to walk past.

Seating Clearance:

30" high tables/counters should allow a 24" wide by 18" deep space for each seated diner.

36" high counters should allow a 24" wide by 15" deep space for each seated diner and at least 15" kneespace.

42" high counters should allow a 24" wide by 12" deep space for each seated diner and at least 12" kneespace.

Clean-Up/Prep Sink Placement:

With only one sink, locate it adjacent to or across from the cooking surface and refrigerator.

Clean-Up/Prep Sink Landing Area:

Include at least a 24" landing space on one side of the sink and 18" on the other.

If all the countertop at the sink is not the same height, plan a 24" landing space on one side of the sink and 3" of countertop frontage on the other, both at the same height of the sink.

Preparation/Work Area:

Include a section of countertop at least 36" wide x 24" deep next to the sink for a work area.



NKBA Kitchen Guidelines (Cont.)

Dishwasher Placement:

Nearest edge of dishwasher should be within 36" of nearest edge of sink. Provide at least 21" of standing space between the edge of the dishwasher and countertop frontage/appliances/cabinets which are placed at a right angle to the dishwasher.

Waste Receptacles:

Include at least 2 waste receptacles, one near the sink and the other nearby for recycling.

Auxiliary Sink:

Provide at least 3" of countertop frontage on one side of the auxiliary sink and 18" on the other side, both at the same height of the sink.

Refrigerator Landing Area:

Include at least 15" of landing area on the handle side of the refrigerator, 15" on either side of a side-by-side refrigerator, 15" of landing space which is no more than 48" across from the front of the refrigerator, and 15" above or adjacent to any under counter-style refrigerator.

Cooking Surface Landing Area:

Include a minimum of 12" of landing area on one side of the cooking surface and 15" on the other.

If cooking surface is at a different countertop height than the rest of the kitchen, then the 12" and 15" landing areas must be the same height as the cooking surface.

For safety reasons, in an island or peninsula situation, the countertop should extend a minimum of 9" behind the cooking surface if the counter height is the same height as the cooking surface.

Cooking Surface Clearance:

Allow 24" between the cooking surface and a protected noncombustible surface above it.

At least 30" of clearance is required between the cooking surface and an unprotected/combustible surface above it.

If a microwave hood is used, then the manufacturer's specifications should be followed.

Cooking Surface Ventilation:

A correctly sized, ducted ventilation system is recommended for all cooking surface appliances. The recommended minimum is 150 CFM.

Code requires that the manufacturer's specifications be followed. Minimum exhaust rate for a ducted hood is 100 CFM and must be ducted to the outside.

Make-up airway may need to be provided. Refer to local codes.

Cooking Surface Safety:

Do not locate cooking surface under an operable window.

Window treatments above cooking surface should not use flammable materials.

Place a fire extinguisher near the kitchen exit away from cooking equipment.

Microwave Oven Placement:

The ideal location for the bottom of the microwave is 3" below the principle user's shoulder, but no more than 54" above the floor.

PRODUCT SPECIFICATIONS

NKBA Kitchen Guidelines (Cont.)

Microwave Landing Area:

Provide at least 15" above, below, or adjacent to the handle side of a microwave oven.

Oven Landing Area:

Include at least 15" next to or above the oven.

A 15" landing area that is not more than 48" away is also acceptable as long as the oven does not open into a walkway.

Combining Landing Areas:

If two landing areas are adjacent to one another, determine a new minimum for the two by taking the longer of the two and adding 12".

Countertop Space:

A total of 158" of countertop frontage, 24" deep, with at least 15" clearance above is needed to accommodate all landing, preparation, work, and storage areas.

Countertop Edges:

Clipped or round corners rather than sharp edges are recommended on all counters.

Storage:

The recommended total shelf/drawer frontage for a small kitchen (less than 150 square feet) is 1400", a medium kitchen (151 to 350 square feet) is 1700", and for a large kitchen (greater than 350 square feet) is 2000".

Sizes:	S	M	L
Wall:	300"	360"	360"
Base:	520"	615"	660"
Drawer:	360"	400"	525"
Pantry:	180"	230"	310"
Misc.:	40"	95"	145"

The totals for wall, base, drawer, and pantry shelf/drawer frontage can be adjusted upward or downward as long as the recommended total stays the same.

Storage At Clean-Up/Prep Sink:

The recommended total for a small kitchen is 400", a medium kitchen is 480", a large kitchen is 560", and should be located within 72" of the centerline of the main clean-up/prep sink.

Corner Cabinet Storage:

At least one corner cabinet should include a functional storage device.

Electrical Receptacles:

GFCI (Ground-Fault-Circuit-Interruptor) protection is required on all receptacles servicing countertop surfaces within the kitchen.

Lighting:

Every work surface should be well illuminated. At least one wall switch-controlled light must be placed at the entrance.

Window/skylight area, equal to at least 8% of the total square footage of the kitchen, or a total living space which includes a kitchen, is required.



NKBA Bath Guidelines

Door/Entry:

Doorway opening should be at least 32", requiring a minimum 2' 10" wide door.

Door Interference:

Entry or fixture doors should not interfere with each other and/or the safe use of fixtures/cabinets.

Ceiling Height:

Bathroom floor to ceiling minimum height is 80". A shower or tub with a shower head shall have a minimum floor to ceiling height of 80" above a minimum area 30" x 30" at the shower head.

Clear Space:

Plan a clear space of 30" from the front edge of all fixtures to any opposite bath fixture, wall, or obstacle.

A minimum space of at least 21" is required in front of lavatory, toilet, bidet, and tub, with a 24" minimum space in front of a shower entry.

Single Lavatory Placement:

The distance from the centerline of the lavatory to the sidewall/tall obstacle should be at least 20".

The minimum distance required is 15". The minimum distance required between a wall and the edge of a lavatory is 4".

Double Lavatory Placement:

The distance between the centerlines of two lavatories should be at least 36".

The minimum distance required is 30".

The minimum distance required between the edges of two lavatories is 4".

Lavatory/ Vanity Height:

The height for a lavatory varies between 32"– 43" to fit the user.

Countertop Edges:

Clipped or round corners rather than sharp edges are recommended on all counters.

Shower Size:

The interior shower size should be at least 36" x 36".

The minimum interior shower size required is 30" x 30".

PRODUCT SPECIFICATIONS

General Cabinet Dimensions:

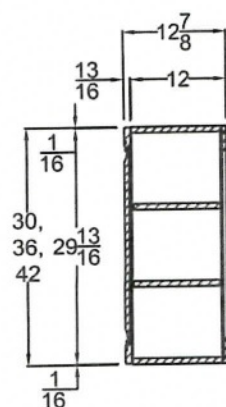

Wall Cabinet:

- 42" Tall Wall Cabinets Have (3) Adjustable Shelves.

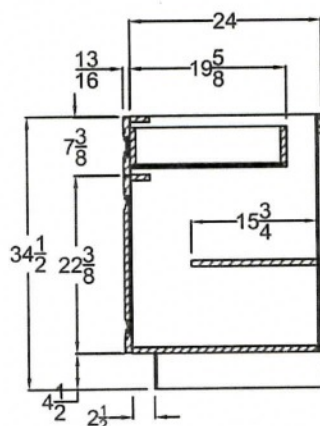

Base Cabinet:

- Colonial Collection Differs From Rest of Cabinet Line:
 - Drawer = 5 7/8" (Height)
 - Door = 24" (Height)

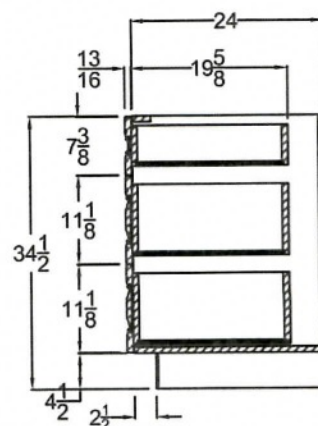

3-Drawer Base Cabinet:

- Colonial Collection Differs From Rest of Cabinet Line:
 - Top Drawer = 5 7/8" (Height)
 - (2) Drawers = 11 15/16" (Height)

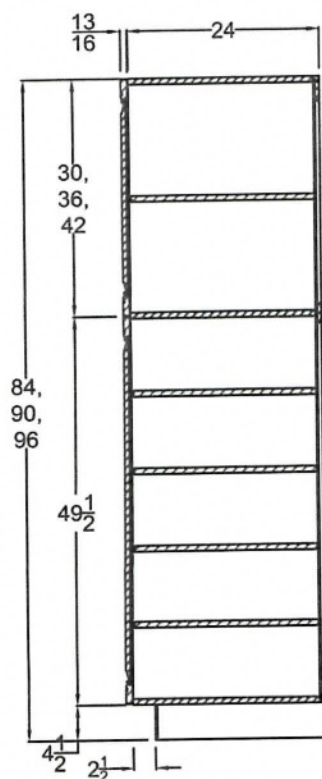

(Tall) Pantry Cabinet:

- 96" Tall Cabinets Have (2) Adjustable Upper Shelves.

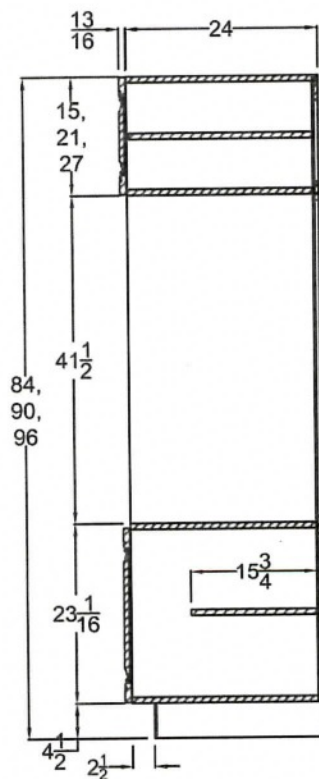

(Tall) Single Oven Cabinet:

- 96" Tall Cabinets Have (2) Adjustable Upper Shelves.

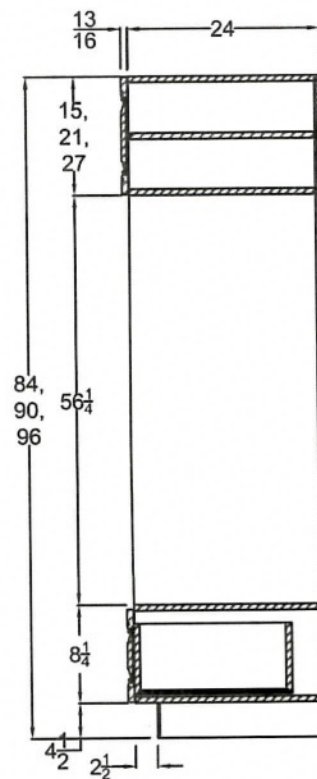

(Tall) Double Oven Cabinet:

- 96" Tall Cabinets Have (2) Adjustable Upper Shelves.